

The Accel Dial is designed for a variety of off-road applications. It is infinitely variable between 0 and 90 degrees with applicable uses that include engine RPM, chassis module inputs and hydraulic pump control.

The Rotary Hand Control is environmentally protected allowing it to be mounted inside or outside the cab.

The Rotary Hand Control unit is equipped with a Hall-effect, non-contact sensor that can be programmed for analog output and/or integrated switches.

The electronics are IP67 sealed and highly EMI resistant (SAE J1843).



## SPECIFICATIONS

<b>PRODUCT LIFE</b>	FULL TRAVEL CYCLES	3 MILLION
<b>ELECTRONICS</b>	SEAL INTEGRITY EMI	IP67 SAE J1843 Compliant
<b>ELECTRICAL</b>	OPERATING VOLTAGE OUTPUT SIGNAL	5, 12, 24, 48 72Vdc as requested Single, Dual output, PWM, CAN Bus as per SAE J-1939
<b>PEDAL ANGLE</b>	DEGREES	90°, 100°
<b>MECHANICAL</b>	LOAD VIBRATION	Initial Load : 0.2Nm 8 Hour, 3-Axis, Random Broadband up to 9G
<b>ENVIRONMENTAL</b>	OPERATING TEMP RANGE STORAGE TEMP RANGE HUMIDITY SAND/DUST	-40°C to 85°C -40°C to 85°C After Exposed to -32°C ~ 70°C (96%) Tested to SAE-J 1455
<b>MATERIALS</b>	MAIN BODY KNOB	Aluminum (ADC12) PA66+GF30%

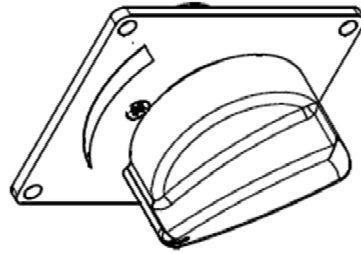
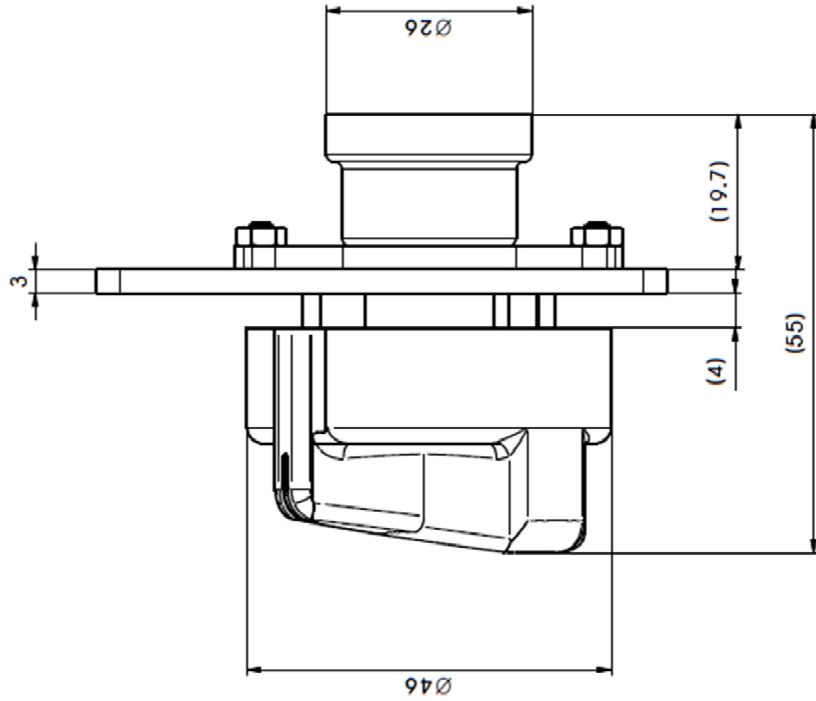
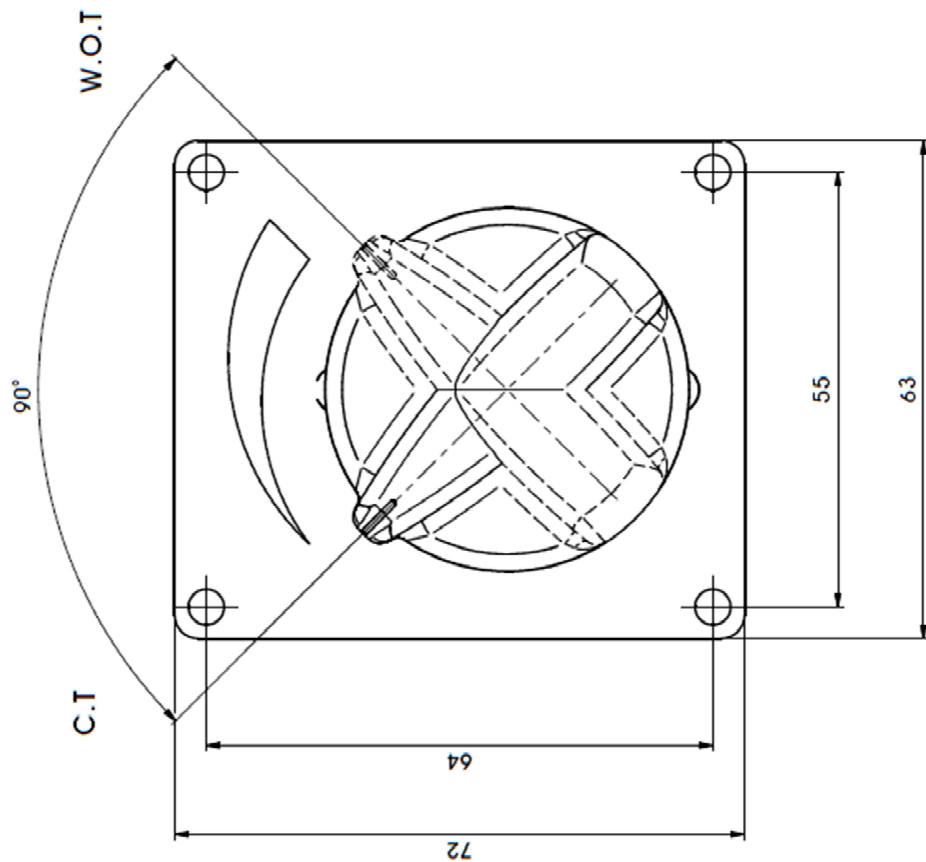

REVISION HISTORY		
REV	DESCRIPTION	DATE
0	Issued	31.Mar.20

[illegible]

REV	DESCRIPTION	DATE	DR	RE	AP
0	Issued	31.Mar.20	M.J.Kim	J.I.Kim	J.H.Lee

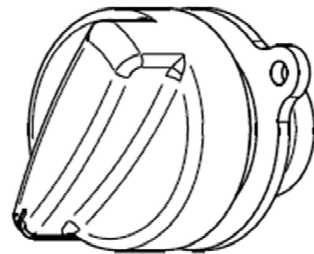
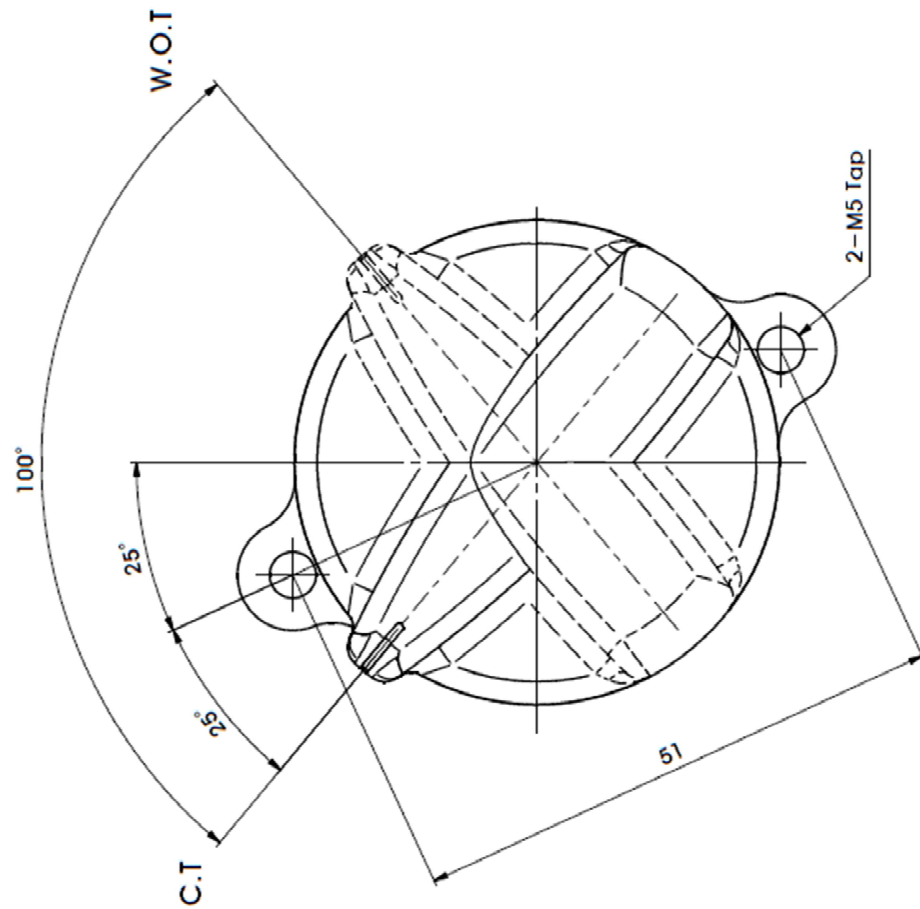
[illegible]

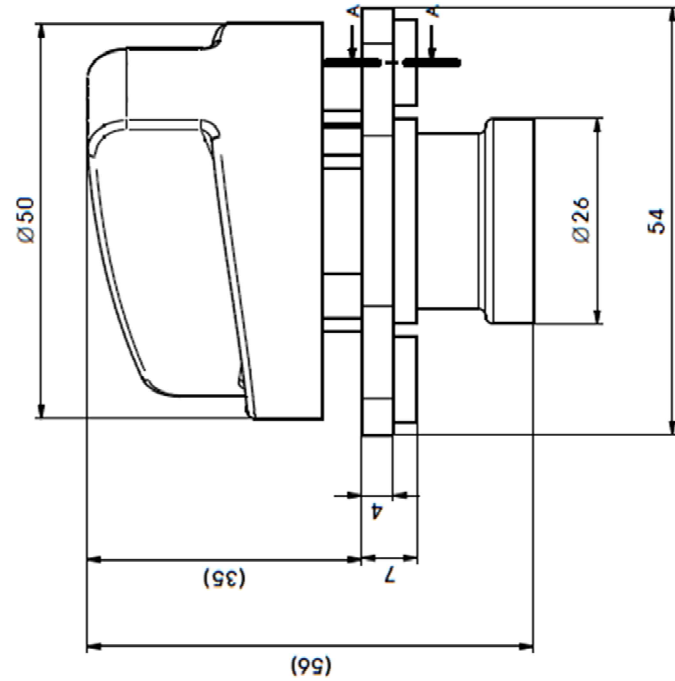
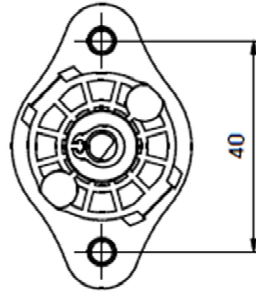
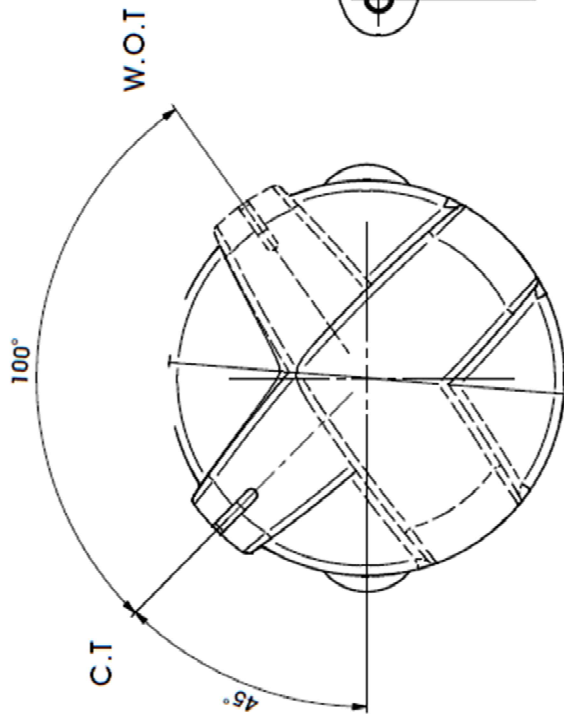

Part No. -

REV  
0DESCRIPTION  
IssuedDATE  
31.Mar.20DR  
M.J.KimRE  
J.I.KimAP  
J.H.Lee

OPTION

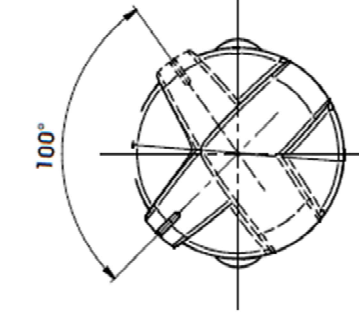

2 Step

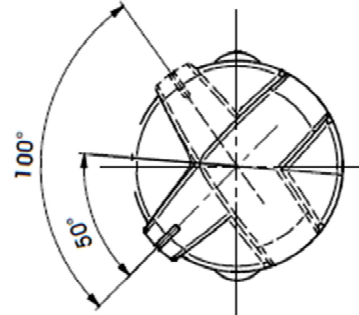

3 Step

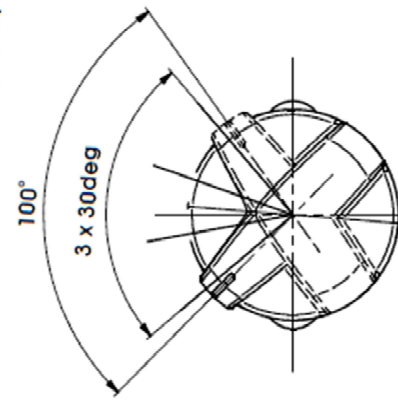

4 Step

ComeSys

Control &amp; Measurement System Limited

Drawing & Control	
Author	J.H.Lee
Checker	J.I.Kim
Reviewer	M.J.Kim
Approved	J.H.Lee

Assembled Model

Assembled Model	
Model	Assembled Model
Material	Assembled Material
Weight	Assembled Weight
Volume	Assembled Volume

Assembled Model

Assembled Model	
Model	Assembled Model
Material	Assembled Material
Weight	Assembled Weight
Volume	Assembled Volume

Assembled Model

Assembled Model	
Model	Assembled Model
Material	Assembled Material
Weight	Assembled Weight
Volume	Assembled Volume

Assembled Model

Assembled Model	
Model	Assembled Model
Material	Assembled Material
Weight	Assembled Weight
Volume	Assembled Volume

Assembled Model

Assembled Model	
Model	Assembled Model
Material	Assembled Material
Weight	Assembled Weight
Volume	Assembled Volume

Assembled Model

Assembled Model	
Model	Assembled Model
Material	Assembled Material
Weight	Assembled Weight
Volume	Assembled Volume

Drawing & Control	
Author	J.H.Lee
Checker	J.I.Kim
Reviewer	M.J.Kim
Approved	J.H.Lee

Assembled Model

Assembled Model	
Model	Assembled Model
Material	Assembled Material
Weight	Assembled Weight
Volume	Assembled Volume

Assembled Model

Assembled Model	
Model	Assembled Model
Material	Assembled Material
Weight	Assembled Weight
Volume	Assembled Volume

Assembled Model

Assembled Model	
Model	Assembled Model
Material	Assembled Material
Weight	Assembled Weight
Volume	Assembled Volume

Assembled Model

Assembled Model	
Model	Assembled Model
Material	Assembled Material
Weight	Assembled Weight
Volume	Assembled Volume

Assembled Model

Assembled Model	
Model	Assembled Model
Material	Assembled Material
Weight	Assembled Weight
Volume	Assembled Volume



REV	DESCRIPTION	DATE	DR	RE	AP
0	Issued	31.Mar.20	M.J.Kim	J.I.Kim	J.H.Lee

